

1 RAMP DETAIL
SCALE= 3/4"= 1'-0"

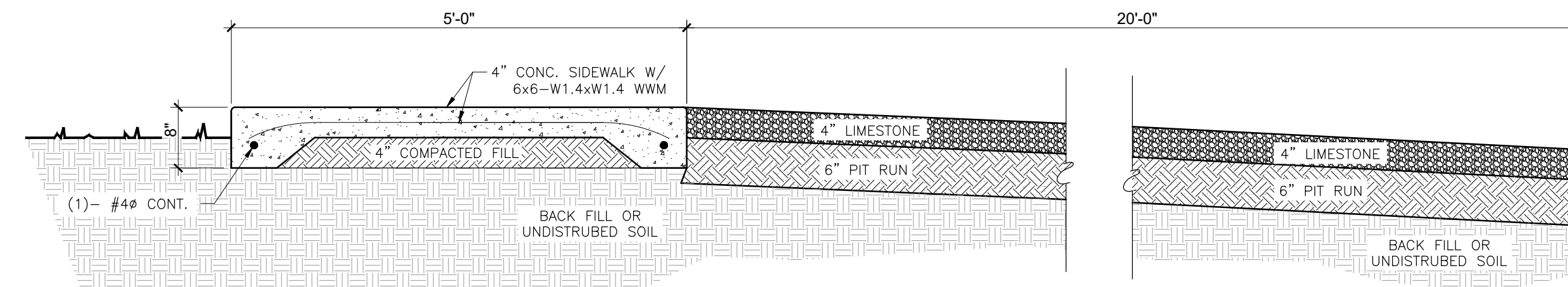

2 CONCRETE WALK @ PARKING AREA DETAIL - TYPICAL
SCALE= 3/4"= 1'-0"

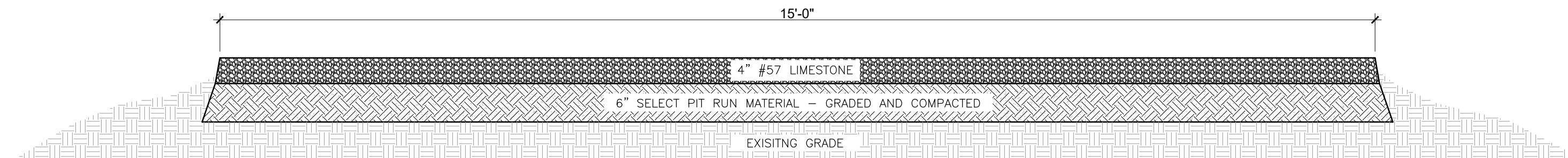

3 ROAD CROSS SECTION @ ROAD - TYPICAL
SCALE= 3/4"= 1'-0"

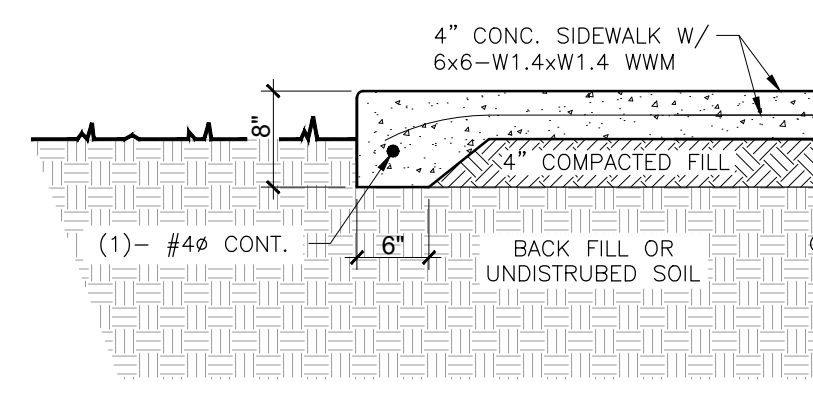

4 SIDEWALK EDGE DETAIL
SCALE= 3/4"= 1'-0"

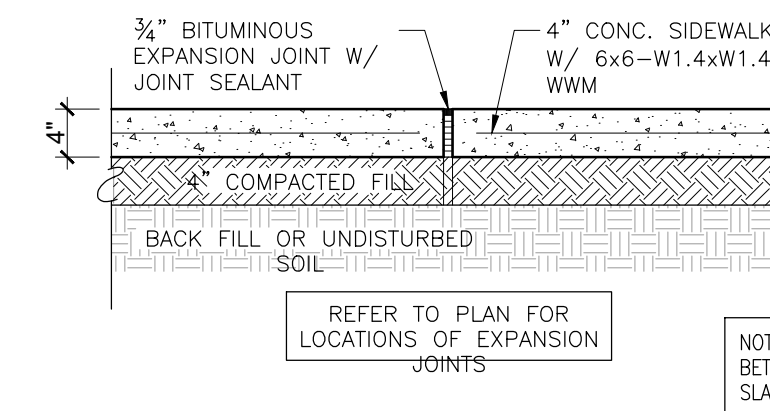

5 SIDEWALK EXPANSION JOINT
SCALE= 3/4"= 1'-0"

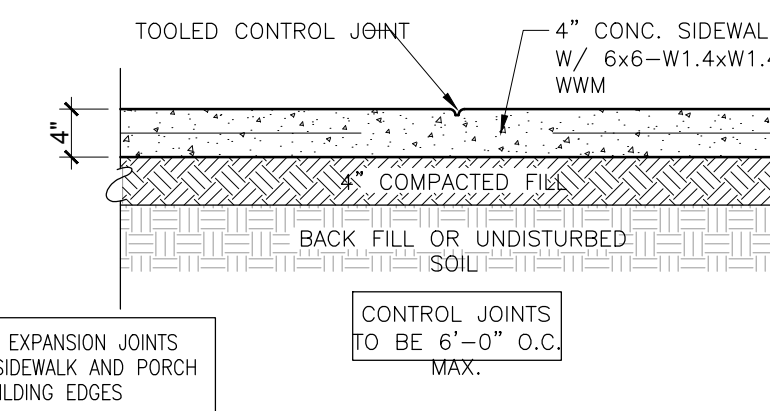

6 SIDEWALK CONTROL JOINT
SCALE= 3/4"= 1'-0"

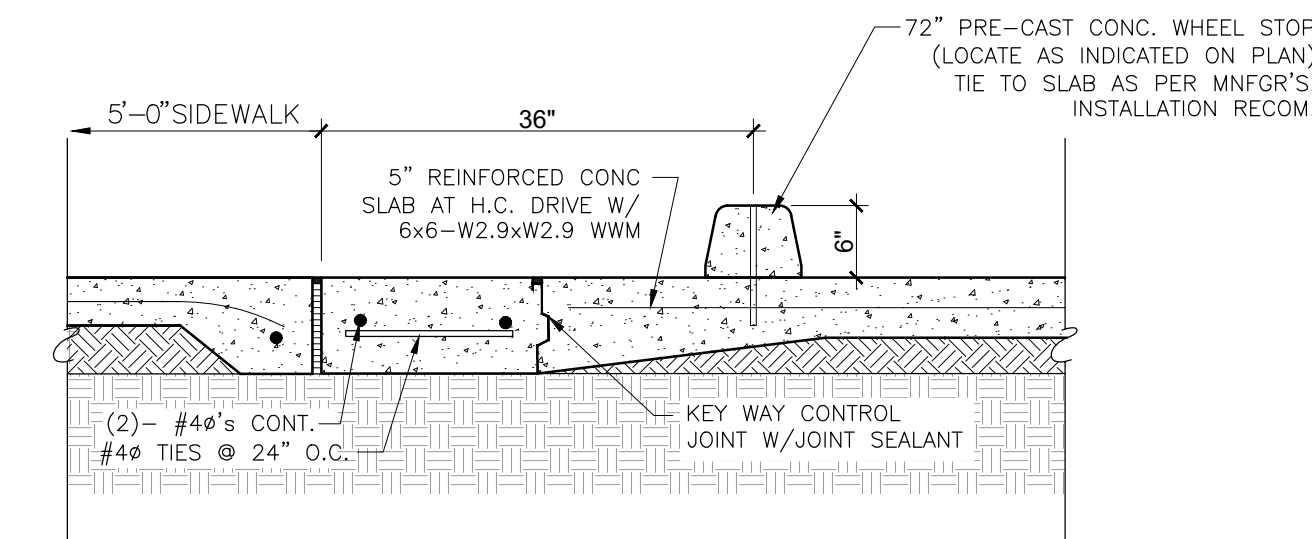

7 WHEELSTOP DETAIL AT H.C. PARKING
SCALE= 3/4"= 1'-0"

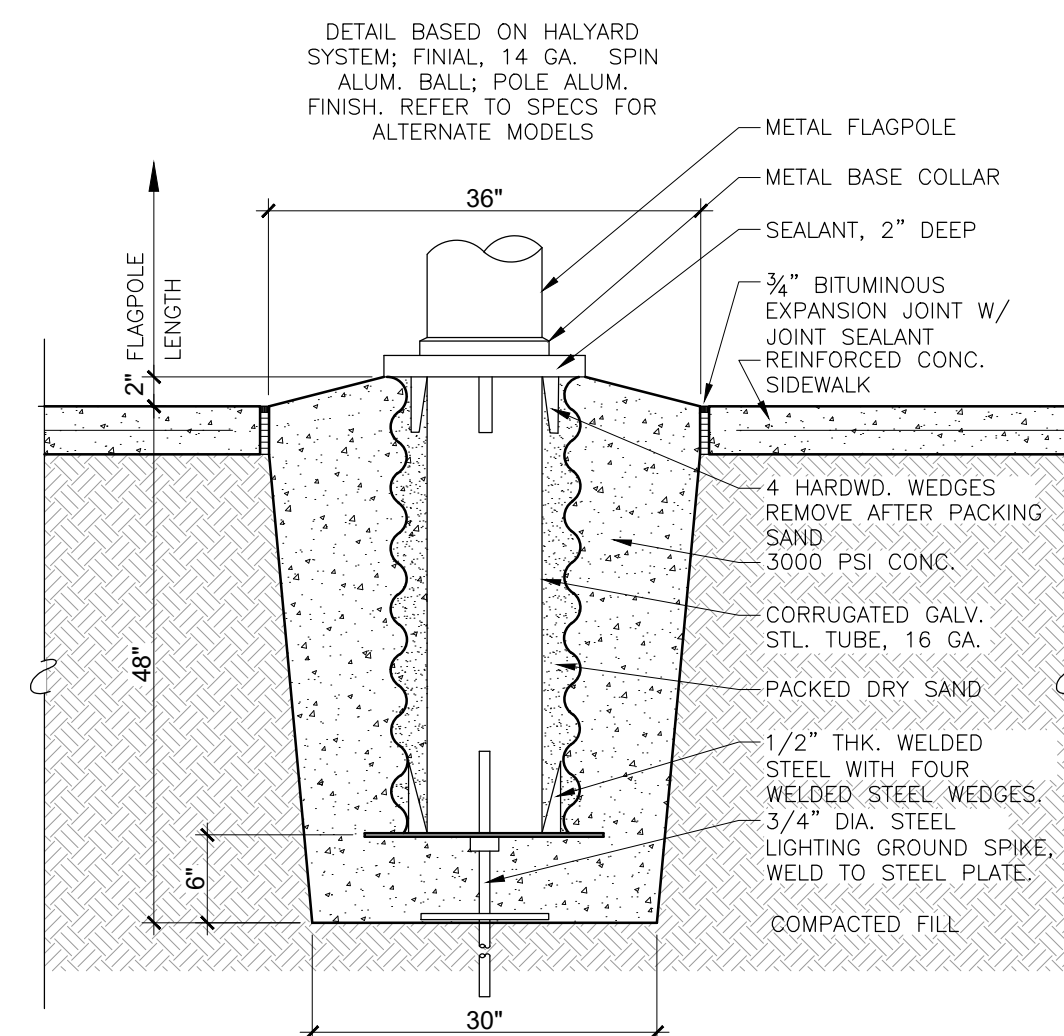

8 FLAGPOLE FOOTING DETAIL
SCALE= 3/4"= 1'-0"

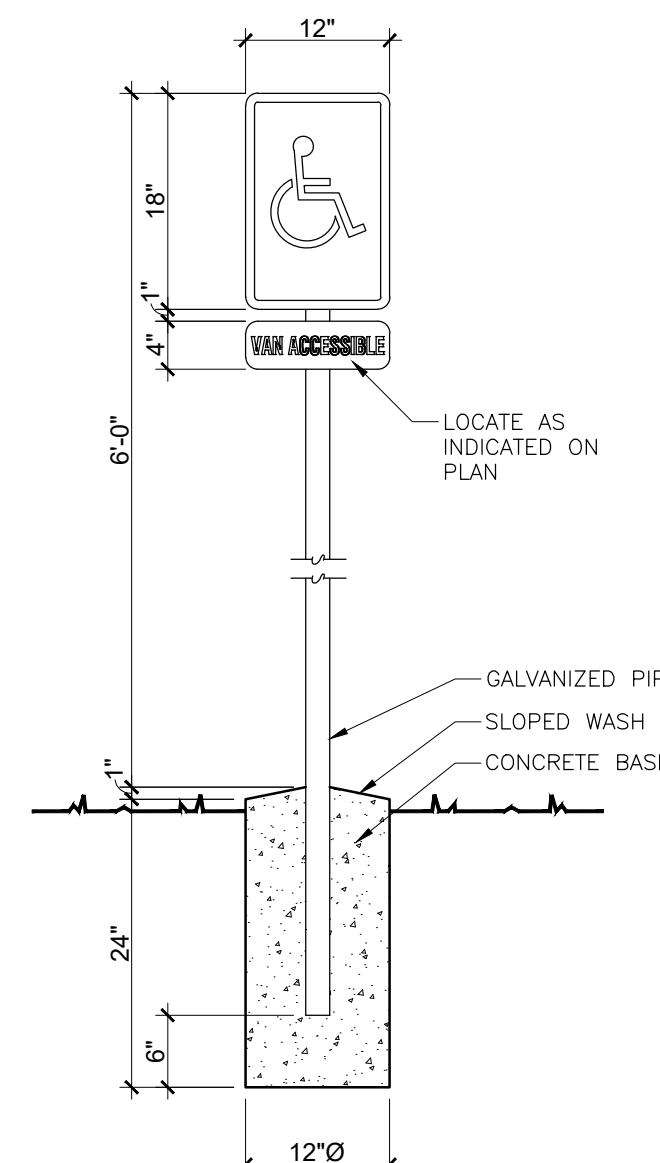

9 H.C. SIGNAGE DETAIL
SCALE= 3/4"= 1'-0"

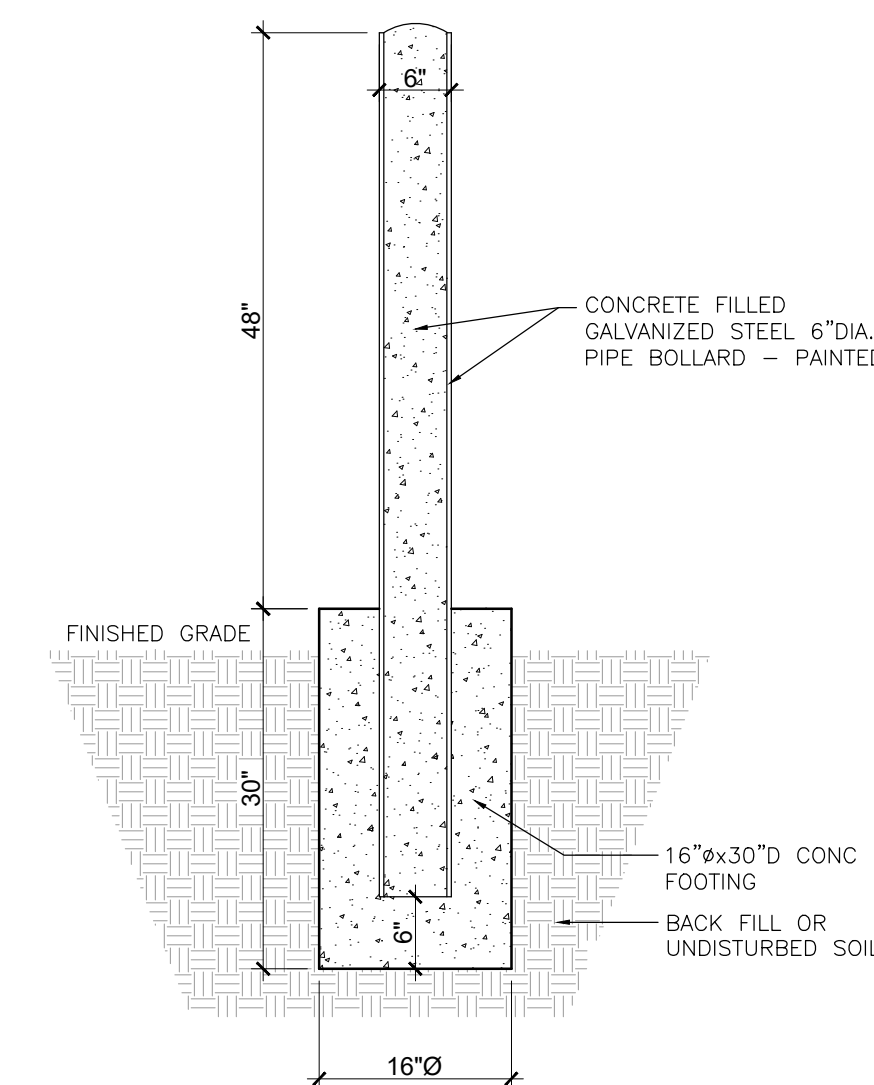

13 PIPE BOLLARD DETAIL
SCALE= 3/4"= 1'-0"

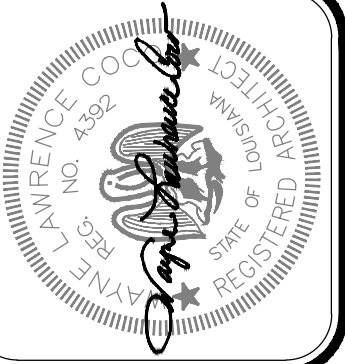

Project No. 0225
Drawn By: BP
Approved By: WAYNE L. COCO
Preliminary Date: MARCH 31, 2026
Release Date:
File:

WAYNE LAWRENCE COCO, AIA, ARCHITECT, L.L.C.
Coco & Company
P.O. BOX 111 - 510 MAIN ST.
SIMMESPORT, LOUISIANA 71369
318.359.3732 / FAX 318.941.2821
a professional architectural company

FUTURE FARMERS OF AMERICA
CONFERENCE CENTER
MANSURA, LOUISIANA AT OLD RIVER